

NOTE: THIS DRAWING WAS PRODUCED BY COMPUTER, DO NOT UPDATE MANUALLY

REV.	ECN NO.	DESCRIPTION	DESIGN	DATE
A0		新版发行	Robin	2020.07.22

The drawing and specification is the property of ALINTA ELECTRONICS CO., LTD. And shall not be reproduced, copied or used in any manner without the prior written consent of ours.

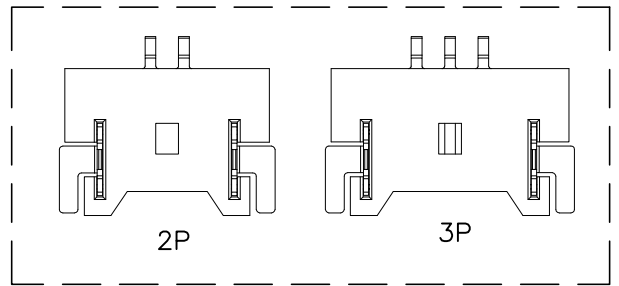
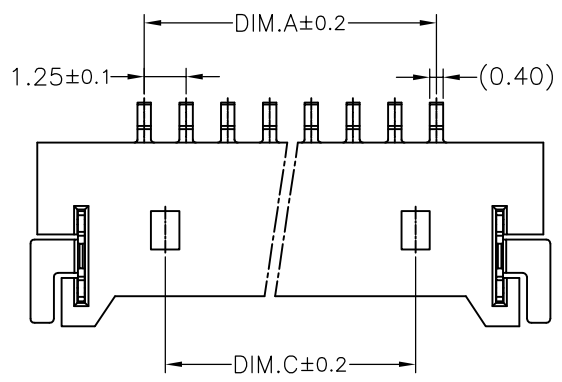

2P、3P图示

- 技术要求:
- 1、接触电阻:  $\leq 20m\Omega$
  - 2、绝缘电阻:  $\geq 100M\Omega$
  - 3、额定电压: 125V AC DC
  - 4、额定电流: 1.0A AC DC
  - 5、耐压: 能承受500V AC/Min ute
  - 6、工作温度:  $-25^{\circ} \sim +85^{\circ}$
  - 7、可焊性试验: 浸锡面积 $\geq 95\%$ 温度 $260^{\pm 5}_{-0}$ °a, 时间  $2.5 \pm 0.5$ 秒
  - 8、铅和镉等六大有害物质含量要符合环保要求

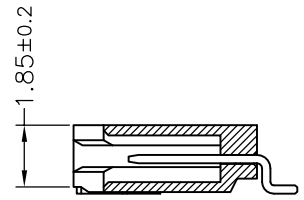
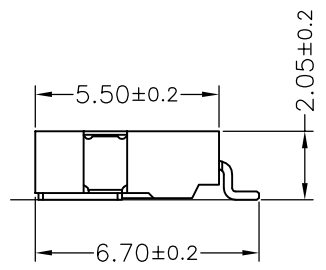
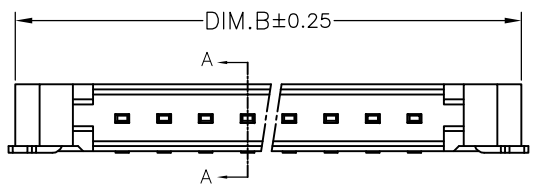

SECTION A-A

Circuit	Dimensions (mm)		
	A	B	C
02	1.25	7.65	-
03	2.50	8.90	-
04	3.75	10.15	2.50
05	5.00	11.40	3.75
06	6.25	12.65	5.00
07	7.50	13.90	6.25
08	8.75	15.15	7.50
09	10.00	16.40	8.75
10	11.25	17.65	10.00
11	12.50	18.90	11.25
12	13.75	20.15	12.50
...	...	...	...
20	23.75	30.15	22.50

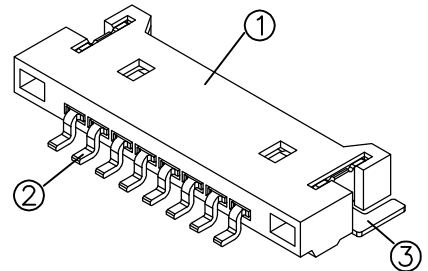

料号说明:  
TJ-22 XX SN976-R  
Poles:02~20

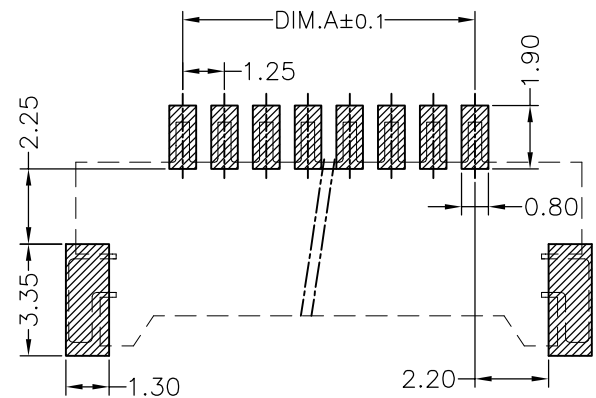

RECOMMENDED P.C.B. LAYOUT  
General Tolerance:±0.05

3	焊片 Fitting Nail	磷青铜 Phosphor Bronze	2	电镀(金): 整个表面镀底镍30u"MIN, 再镀锡0.8u".
2	端子 Contact	磷青铜 Phosphor Bronze	n*1	电镀(金): 整个表面镀底镍30u"MIN, 再镀锡0.8u".
1	基座 Wafer	LCP(UL94V-0)	1	本色
序号	名称	材料	数量	附注

GENERAL TOLERANCE		日期	2020.07.22	UNITS	SCALE	 Alinta Electronics Co., Ltd.			
X.	±0.35	X°	±5°	mm	1:1				
.X	±0.25	.X°	±3°	REV.	SHEET				
.XX	±0.20	.XX°	±2°	A0	1/1				
		核准		SIZE	C	品名:	A1254-SMT-nAW卧贴针座系列		
		审核		A4		料号:	SEE TABLE	图号:	DWG-TJ-976
		制图	Robin						